

Gallery at Elizabeth House – room layout

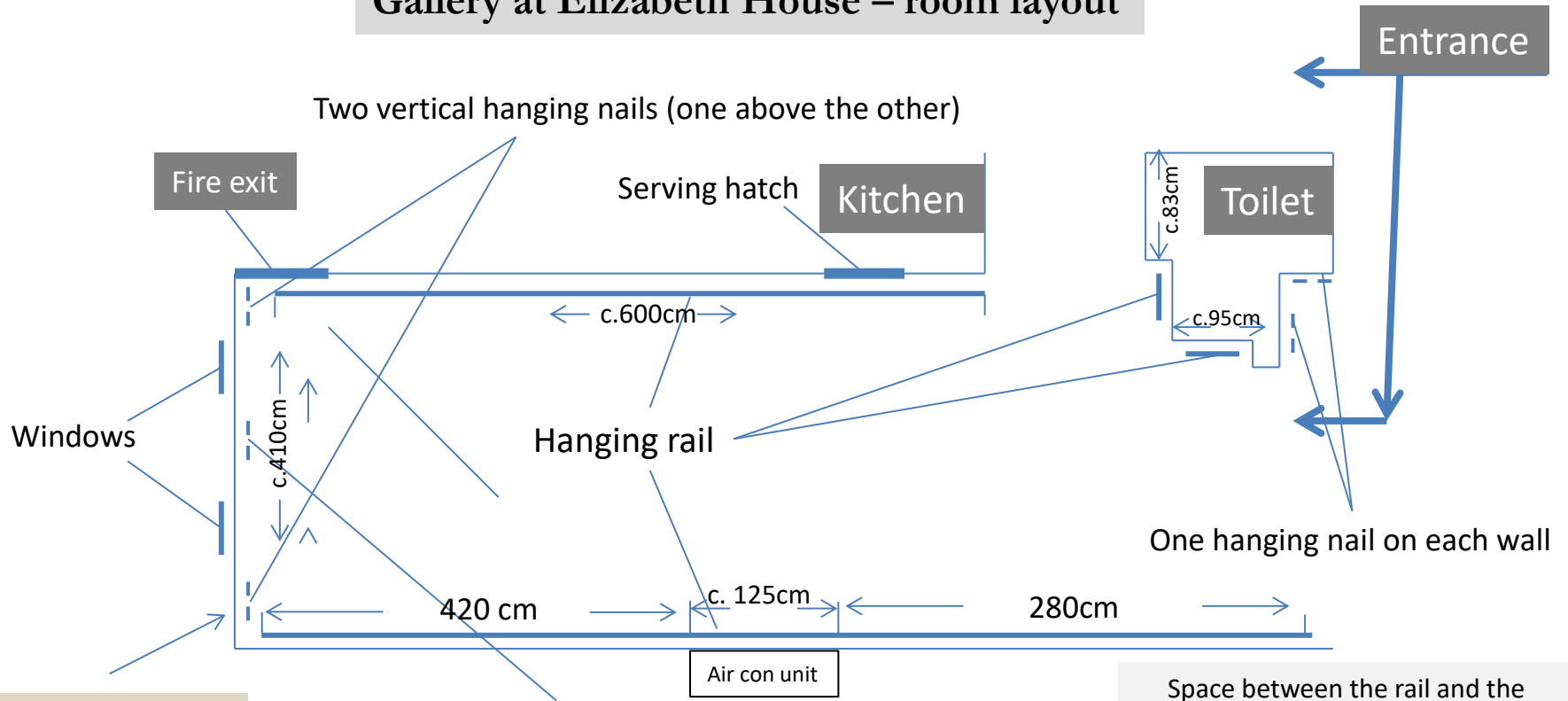

On this side there is some equipment which is installed immediately above the nail which may limit the use of this side

One hanging nail – ideal for a large painting

Space between the rail and the tops of radiators is 140cm, and 110cm below the air conditioning unit (ie the effective hanging area)

Normal arrangement is a total of c 20 cords hanging from the hanging rail, with c 35 'zippers' or hooks. The cords can be moved along the rail and we have a few spare cords. Hooks can be added or taken off each cord, and we have a few spare hooks. Spares are in a box in the cupboard to the left of the reception desk.